

# C.ME™

## Monitor arm

### Technical Specifications.

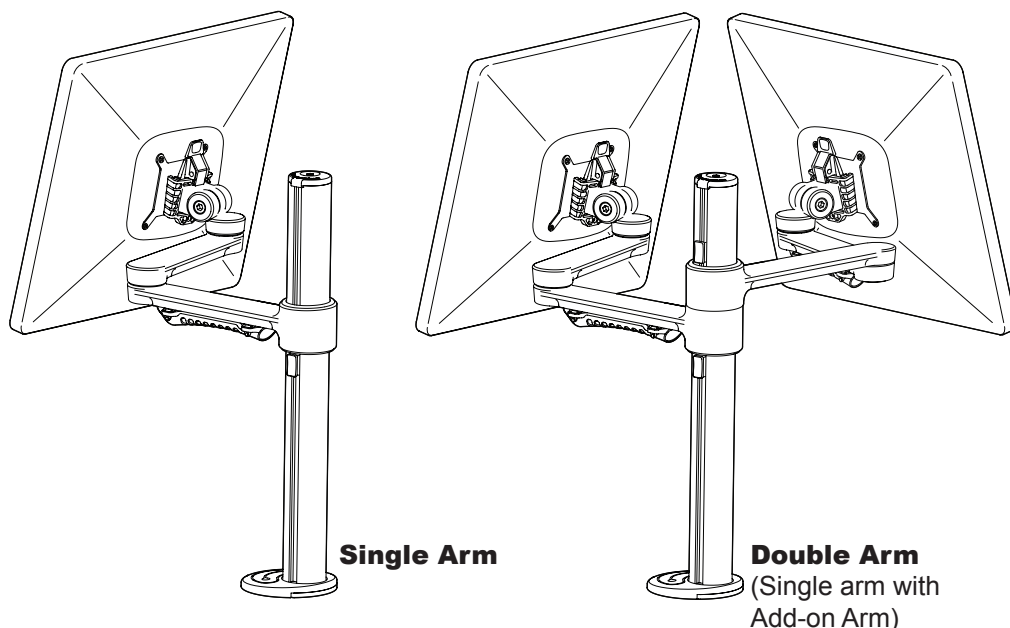

The **C.ME™** Monitor Arm is made to the highest quality standards and combines a range of innovative features:

- Easy and safe push-button monitor position adjustment from a seated position
- Quick release with 90 degree portrait to landscape screen rotation and secure fastening option
- Discreet, effective cable management that allows for easy monitor adjustment
- Bolt through or desk clamp mounting included in the box
- Elegant, simple design appeal with 3 colour options to suit your work environment

#### Specifications

|                       |   |
|-----------------------|---|
| Weight Capacity       | 8kg (17.6lbs) per Arm                               |
| Height Adjustment     | Single Arm 330mm<br>Double Arm 250mm                |
| Tilt / Pan Adjustment | 110 deg / 180 deg                                   |
| Monitor Mounting      | All VESA compliant monitors<br>(75 or 100mm square) |
| Worktop Thickness     | Bolt Through 18 - 33mm<br>Desk Clamp 18 - 33mm      |

#### Colours and Finishes

- **Polished** - Polished Arms, Silver Post, Black Detailing
- **White** - Gloss White Arms, Silver Post, White Detailing
- **Black** - Matte Black Arms, Black Post, Black Detailing

#### Warranty

7 Year limited warranty

#### Tilt & Pan - 110 Deg Tilt & 180 Deg Pan Adjustment

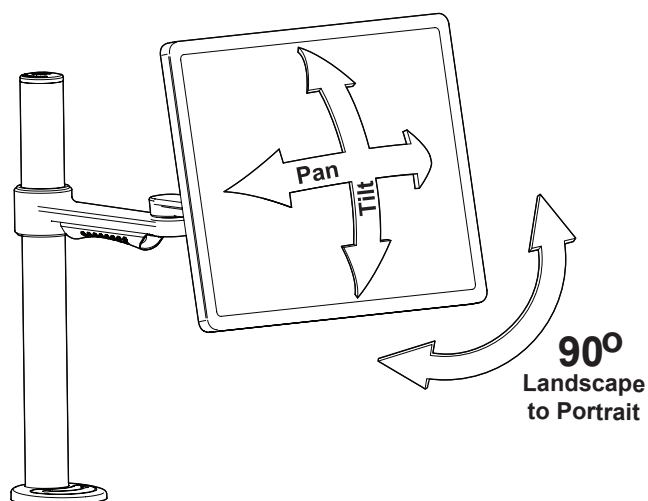

#### Mounting Options

- Both are provided

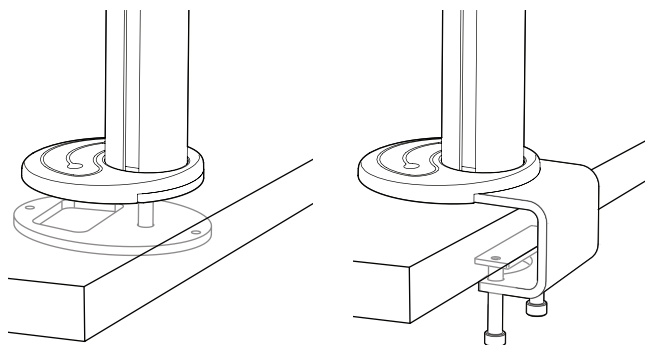

Bolt Through

Desk Clamp

## Single Arm - Side View

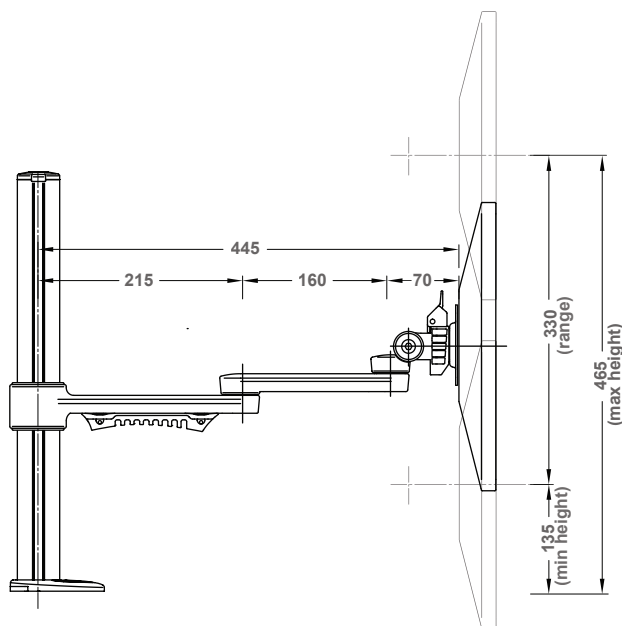

## Double Arm - Side View

- Add-on-Arm allows for screens to be mounted at the same height or independently adjusted

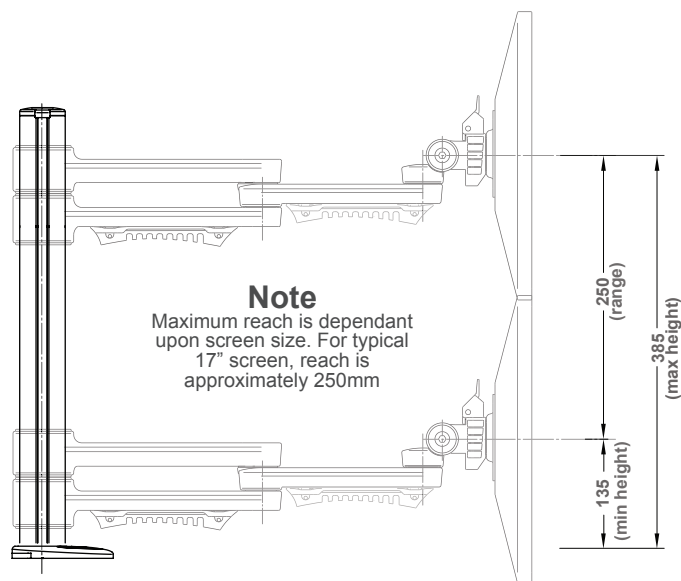

### Note

Maximum reach is dependant upon screen size. For typical 17" screen, reach is approximately 250mm

## Worktop Cut Outs - Recommended Hole Offsets

- Choose 1 of 3 cutout sizes, (Worktop offsets are only recommendations)

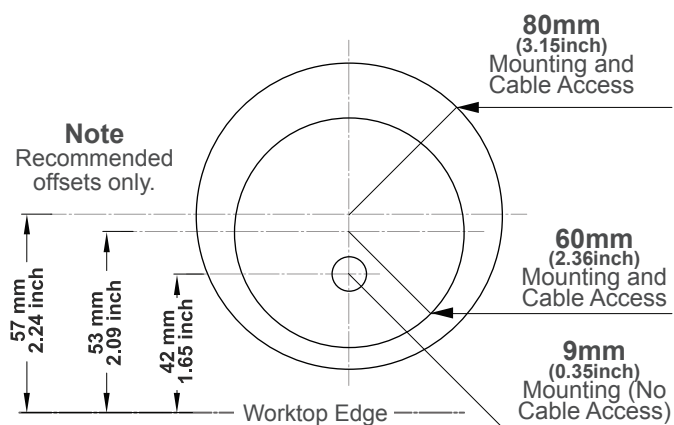

**Note**  
Recommended offsets only.

## Add-on-Arm - Installation

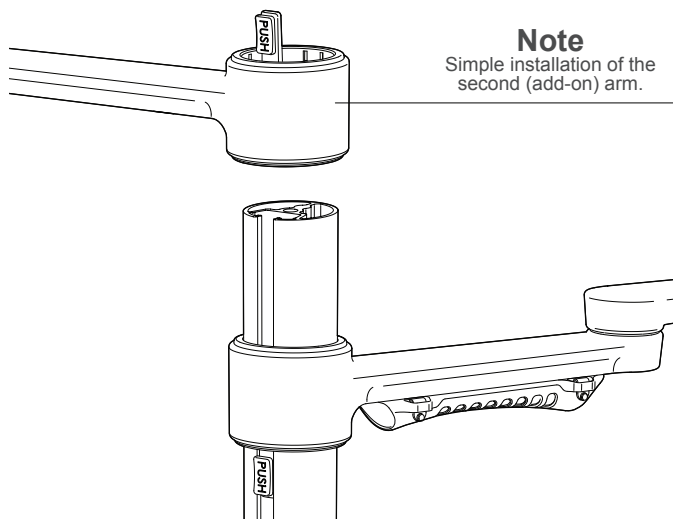

### Note

Simple installation of the second (add-on) arm.

## VESA Mounting

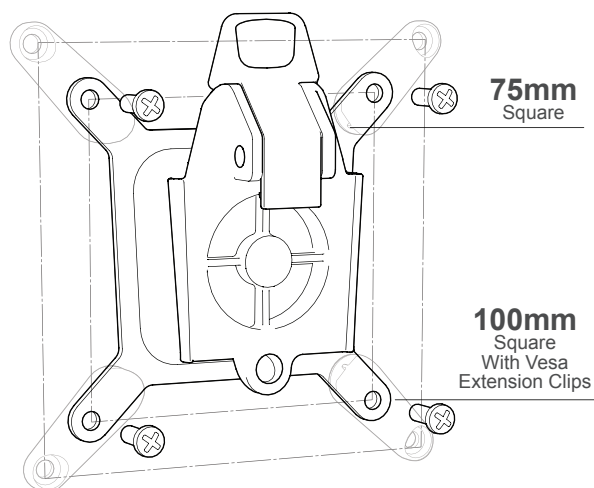

## Quick Release Mounting - Safe and Simple

- Grub Screw for security locking

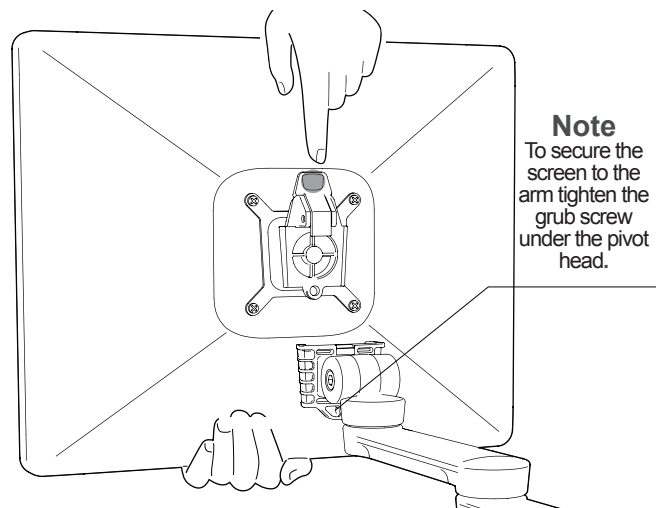

### Note

To secure the screen to the arm tighten the grub screw under the pivot head.